

BSCW95ZC

FOR CNH 2000 SERIES ROW UNITS

INSTALLATION INSTRUCTIONS

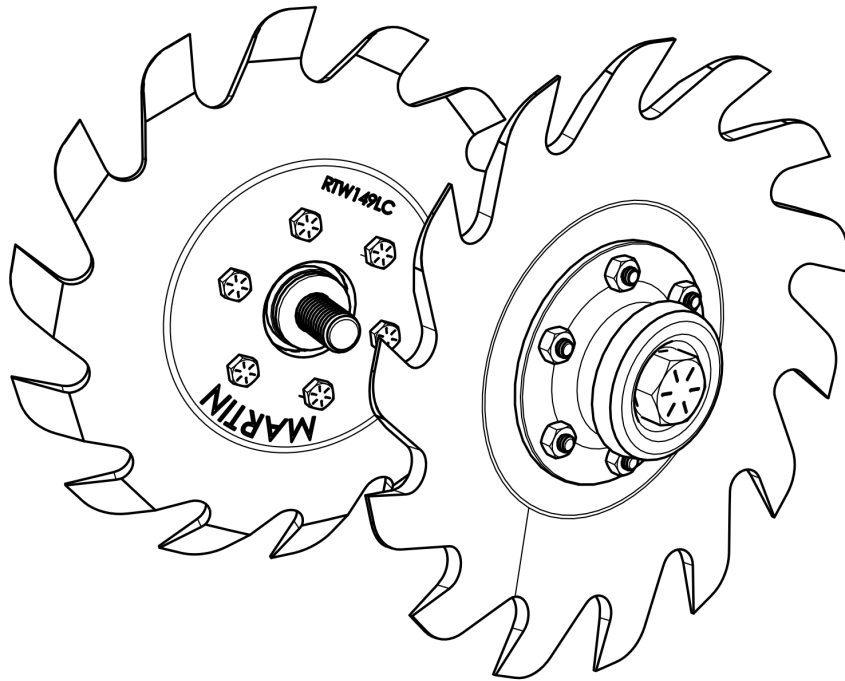

Martin Planter Attachments

Martin Industries LLC

206 Elk Fork Road

Elkton, KY 42220

Telephone: 270-265-5817

E-Mail: martin@martintill.com

www.martintill.com



INSTALLING BSCW95ZC WHEELS TO CASE IH 2000 SERIES

- 1) Remove the existing wheels by removing the dust cover and unthreading M16X45 bolt.
- 2) Remove the bolt and detach the assembly.
- 3) Pass the new provided M16 bolt through the Dust Cover and one thick 5/8" washer as shown below.
- 4) Pass the bolt through the hub and add one thin and one thick 5/8" washers.
- 5) Attach the assembly to the planter. Tighten the bolt to 112 ft-lbs. Be sure rotation direction is as shown in the pictures for both wheels. Use the wheel on the opposite side if the rotation direction is opposite. Make sure that the beveled side of both wheels are located inside and the Cuped side is facing outward from the Closing arm as shown.

Note: Closing wheel pressure may have to be varied to obtain desired results.

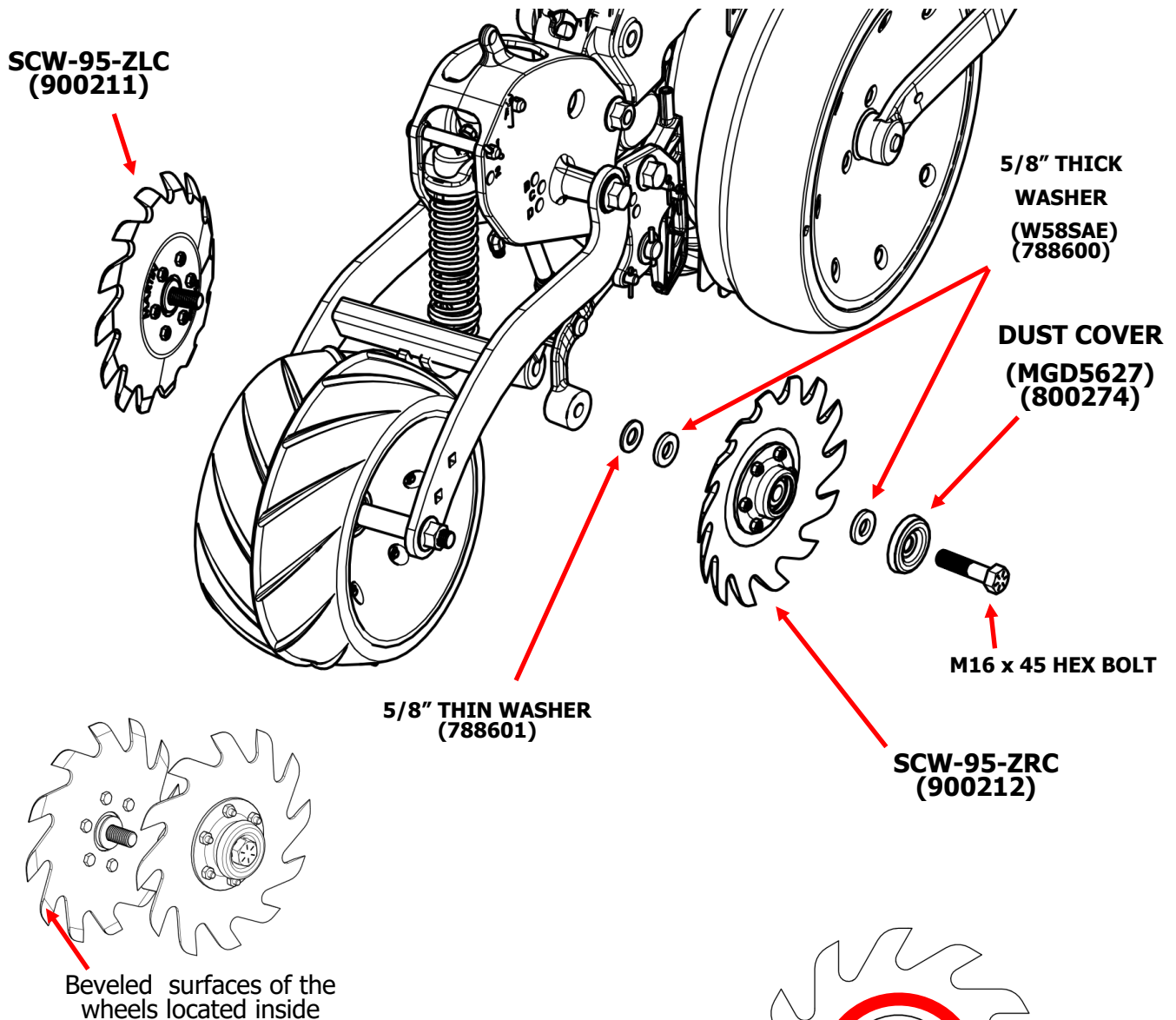

Hardware Provided

- | | |
|-------------------------------|-------|
| 1) M16 X 45 Hex Bolt | Qty 2 |
| 2) 5/8" Thick Washer (W58SAE) | Qty 4 |
| 3) 5/8" Thin Washer (W58FYZ) | Qty 2 |
| 4) Dust Cover (MGD5627) | Qty 2 |

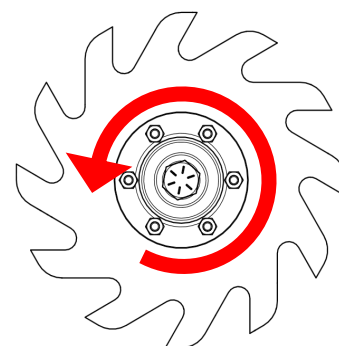

Rotation Direction