



C HUB BEARING ADDENDUM

ALTERNATE BEARING FOR C HUB ASSEMBLIES

As of January 2021, Martin C-Hub assemblies are machined with a secondary groove to allow for substituting two 205RVA Bearings (800640) for the standard W5205RSS51 (800248) as shown below.

If changing from a W5205RSS51 to 2x 205RVA Bearings, follow the below steps.

1. Unbolt the Wheel and Hub assembly from the Frame by removing the Dust Cap and 5/8 Hex Bolt from Front of Hub.
2. Remove step-down spacer (800241) from the hub. (a shortened replacement is provided 800241-205RVA or 1/0 Top Link Bushing).
3. Remove Retainer Ring (800238) from front groove and pull out the W5205RSS51 Bearing.

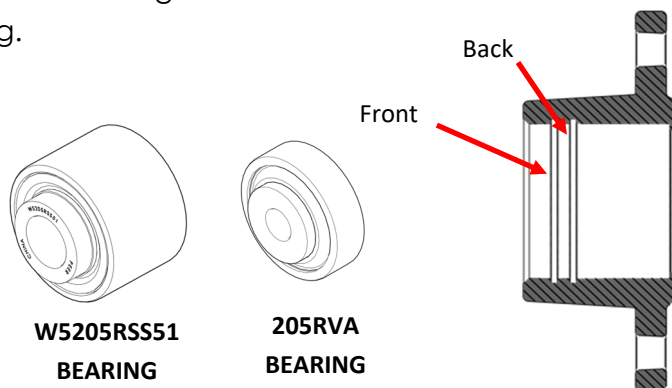

5. Install the first 205RVA bearing with the extended inner race facing out towards the back of the hub as shown.
6. Install second bearing with extended inner race facing out front towards cap as shown. (opposite of first bearing)

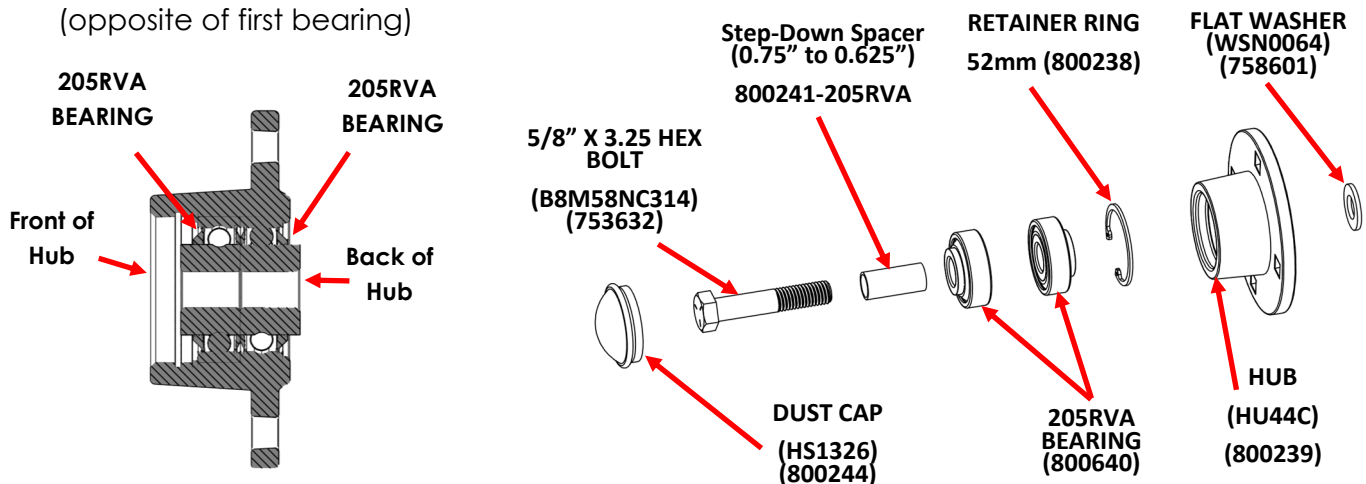

7. Reinstall Retainer Ring (800238) in the **Back** snap ring groove shown in Step 3 image.
8. When reinstalling the Wheel and Hub assembly, add an extra 5/8 Washer (758601) behind the bearing. If using scrapers, this will mean having a washer between the bearing and the scraper. If not using scrapers, two washers will be between the bearing and frame.
9. Add the provided shortened step-down spacer (800241-205RVA).
10. Bolt the Wheel and Hub assembly to the Frame. Torque bolt to 150 ft-lbs. Reinstall dust cap.