

CNH 2000 CLOSING KIT

INSTALLATION INSTRUCTIONS

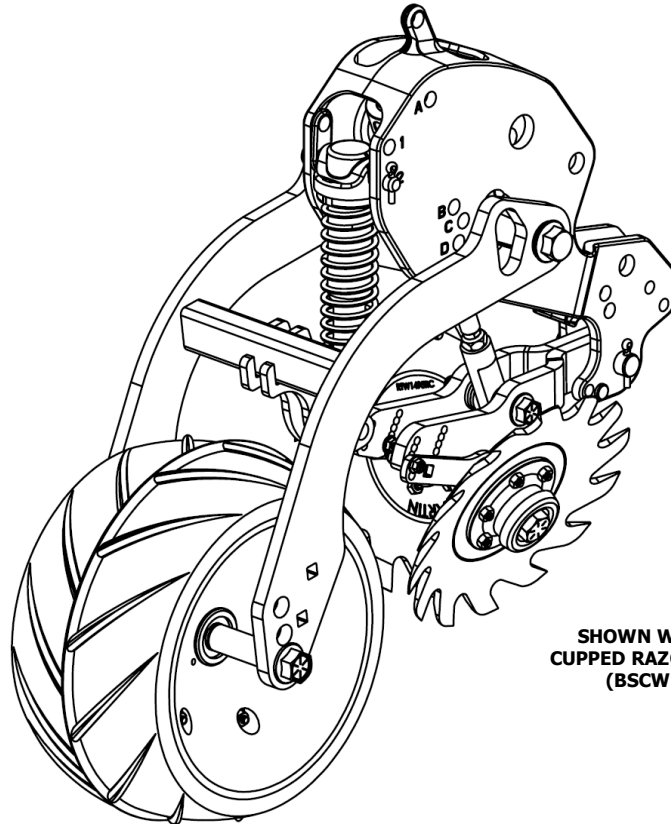

SHOWN WITH 9.5"
CUPPED RAZOR WHEELS
(BSCW95ZC)

FOR EXPLODED VIEWS,
SEE PAGES 13,14 & 15



Martin Planter Attachments

Martin Industries LLC

206 Elk Fork Road

Elkton, KY 42220

Telephone: 270-265-5817

E-Mail: martin@martintill.com

www.martintill.com



STEP 1 :REMOVE THE PRESS WHEEL

Remove the press wheel from the Factory Swing arm by removing the bolt, Retain the bolt, spacers and lock nut for later use.

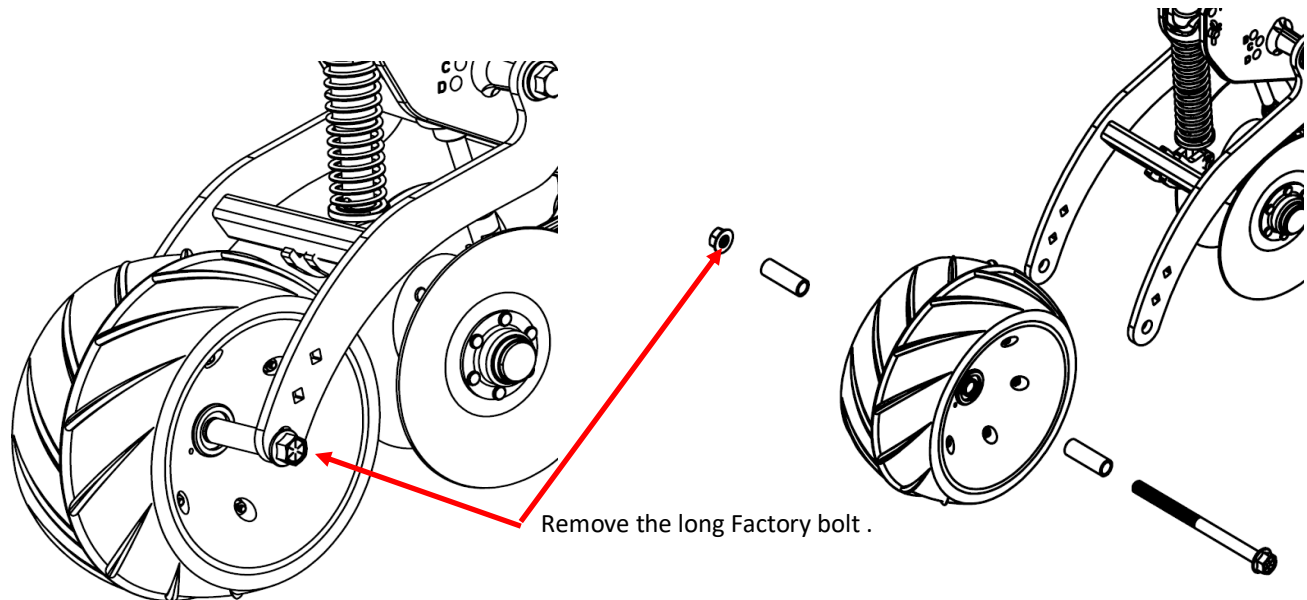

STEP 2 : REMOVE THE FACTORY SWING ARM FROM THE UNIT

- 1) Remove the clevis pin from the spring assembly .
- 2) Remove factory swing arm by removing pivot bolts retain bolt and bushing for later use.

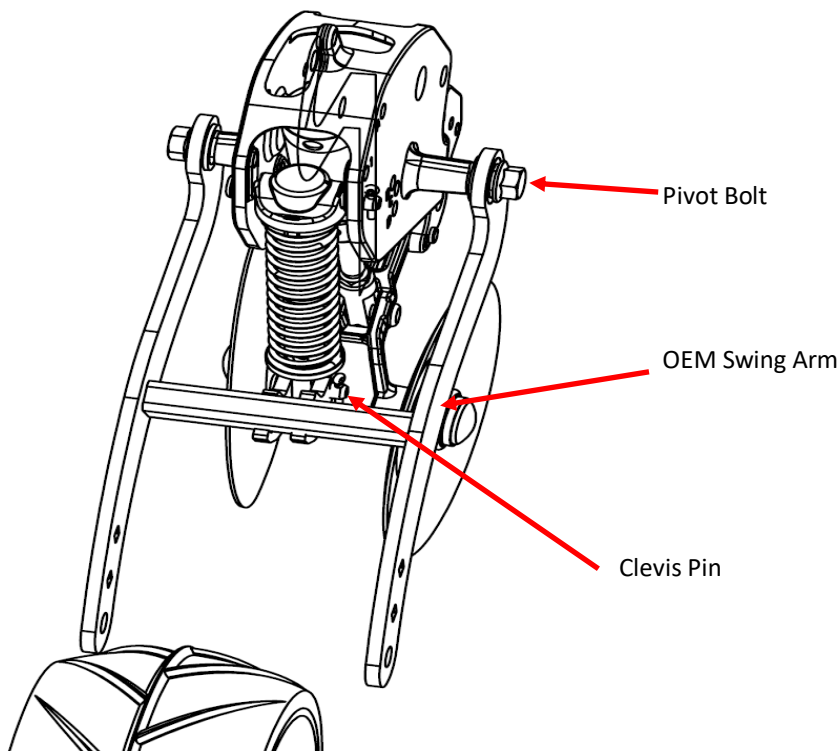

STEP 3 : REMOVE THE CLOSING SYSTEM

- 1) Remove the clevis pin connecting the end of the Spring Assembly and retain the pivot pin for later use.
- 2) Remove pivot pin from closing wheel arm.

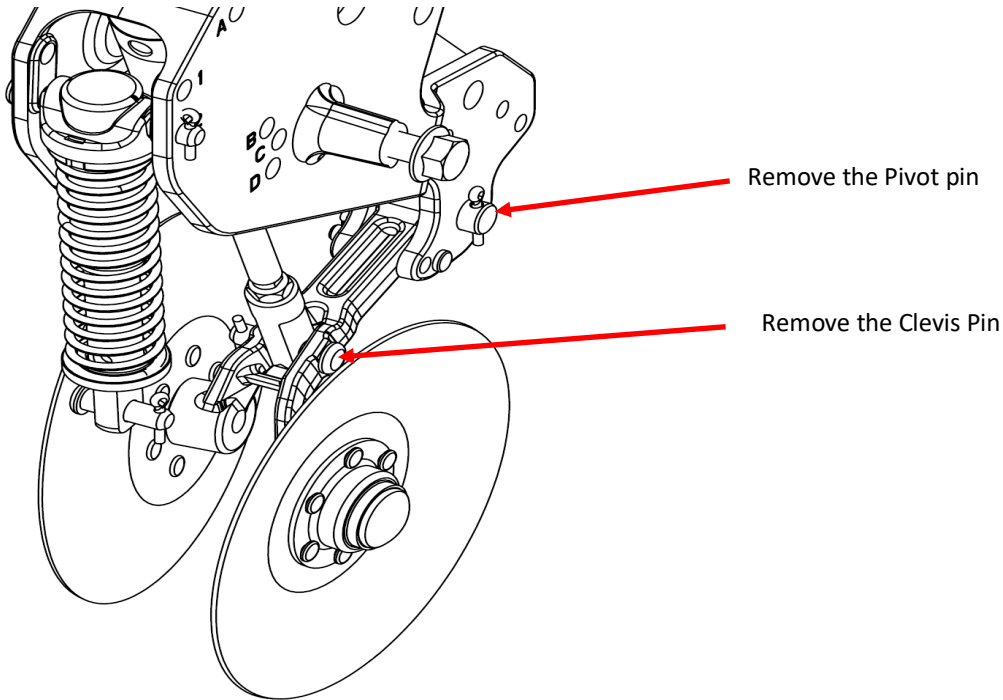

STEP 4 : CHOOSE THE DESIRED AXLE ORIENTATION

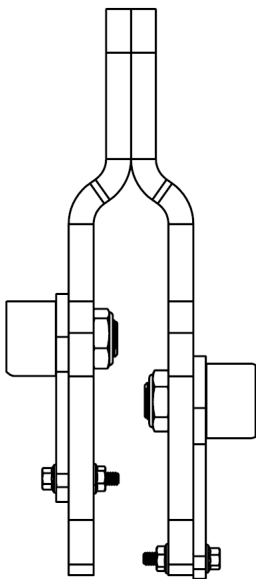

Left Leading
(Top View)

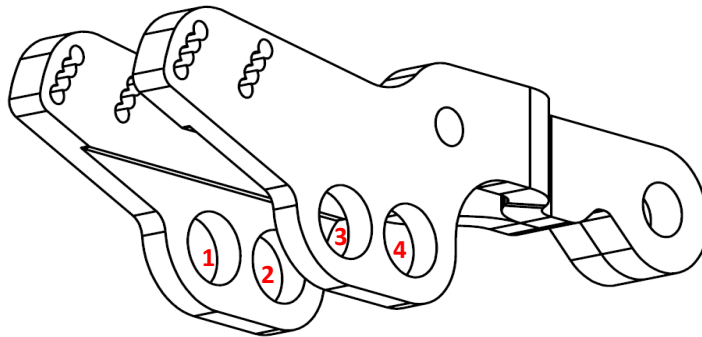

NOTE: We recommend matching Left leading and Right leading to match the OEM Configuration

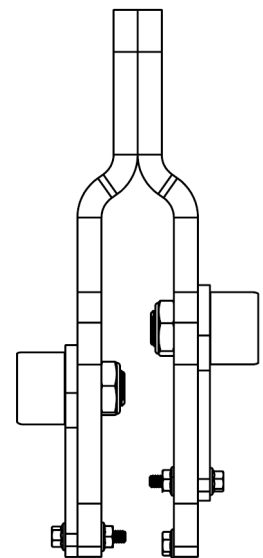

Right Leading
(Top View)

The different axle configurations are shown below:-

OPTION A : STAGGERED - LEADING RIGHT

ONE AXLE IN THE REAR HOLE (Hole number 1)

ONE AXLE IN THE FRON HOLE (Hole number 4)

NOTE:- Recommended Configuration for half of machine

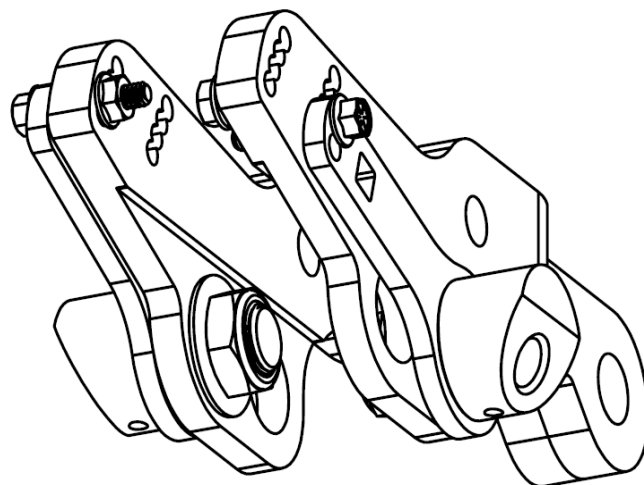

OPTION B : STAGGERED - LEADING LEFT

ONE AXLE IN THE REAR HOLE (Hole number 2)

ONE AXLE IN THE FRON HOLE (Hole number 3)

NOTE:- Recommended Configuration for half of machine

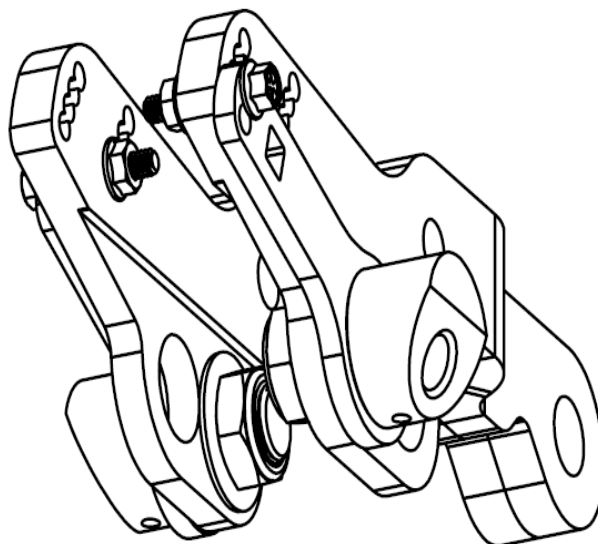

OPTION C : SIDE TO SIDE

Either both axles in the front or both in rear

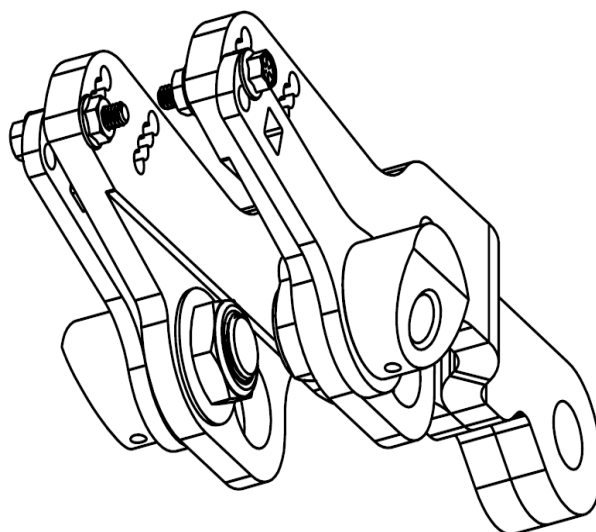

STEP 5 : ASSEMBLE THE CLOSING SYSTEM

PARTS LIST FOR 900250 CNH 2000 CLOSING WHEEL SYSTEM :-

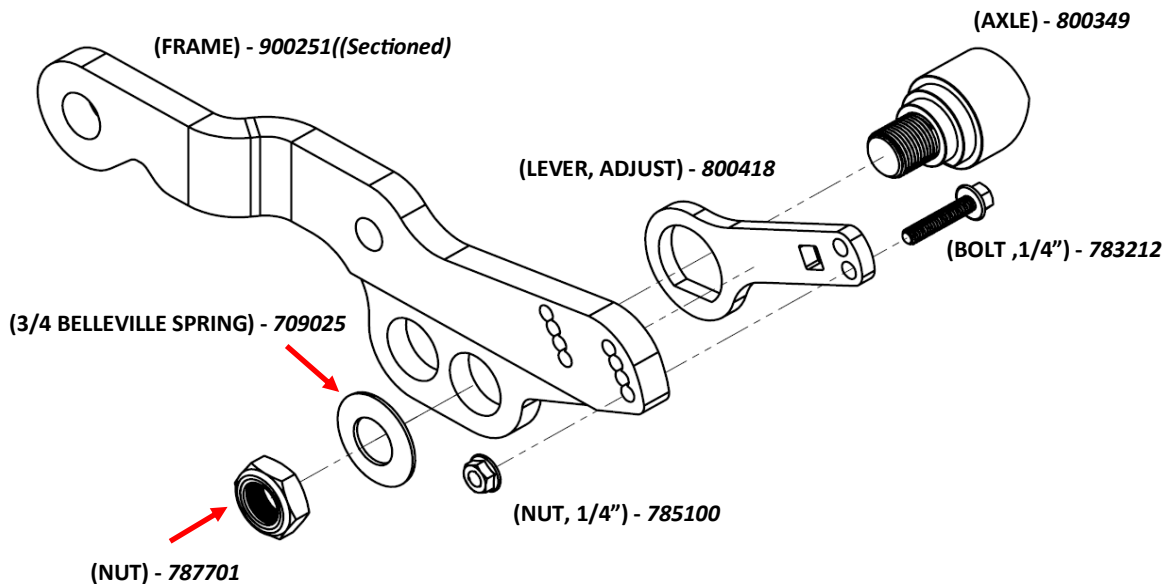

1) Once the configuration is decided, match the shoulder on the axle to the adjusting lever arm (800418) and insert the axle passing through the lever to the designated whole. As shown in the image on the right.

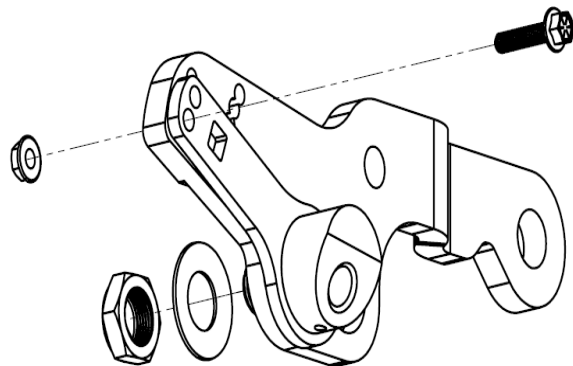

2) Place a Belleville washer/spring on the other side of the arm over the threads of the axle and then secure those threads with 3/4 Nyloc Nut.

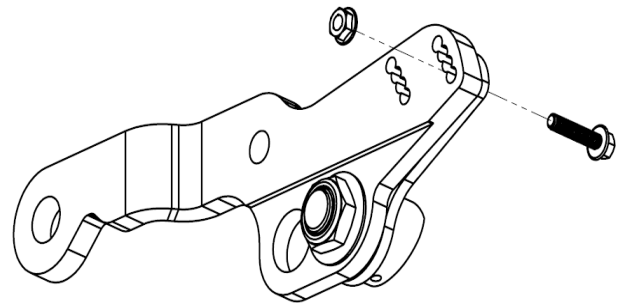

NOTE: DO NOT OVER TIGHTEN , THE AXLE SHOULD ROTATE WITH SOME RESISTANCE FELT

3) Insert the 1/4 bolt through the adjusting lever and frame at your desired angle, then secure the other end of the bolt with 1/4 Nut.

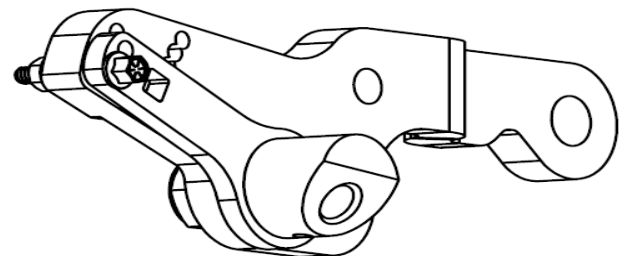

NOTE: SEE PAGE 8 FOR GUIDE TO SET TOE-IN

- 4) Attach end of the new closing frame to the Row unit using existing pivot pin
- 5) Determine if you have long rod end or the short, if you have short consider upgrading to long rod end or order optional bushing to limit down travel so that the cylinder does not stroke out all the

NOTE: Condition to use the Optional Bushing

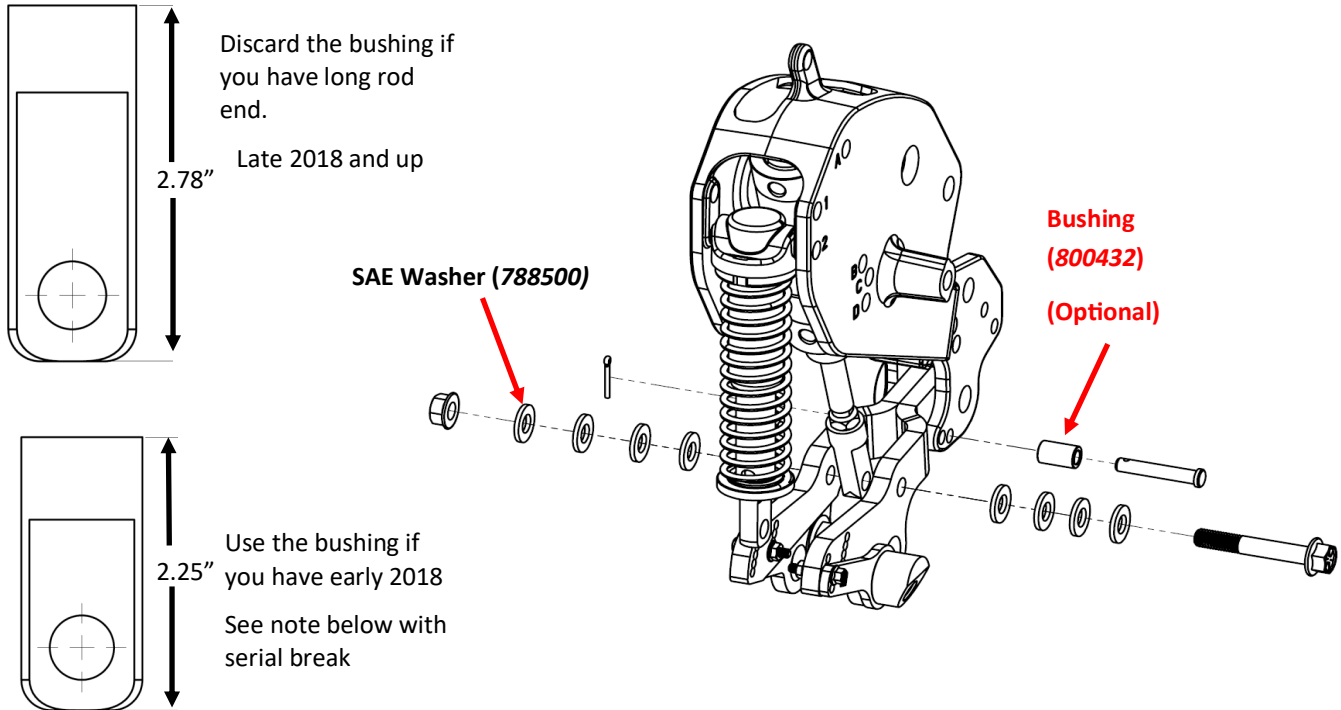

- 6) Connect the cylinder to the closing frame using four 1/2" SAE Flat Washers per side using with 1/2" X 3 1/4 flange bolt and lock nut.

NOTE: DO NOT OVER TIGHTEN, BOLT SHOULD TURN FREELY ACTING AS A CLEVIS PIN.

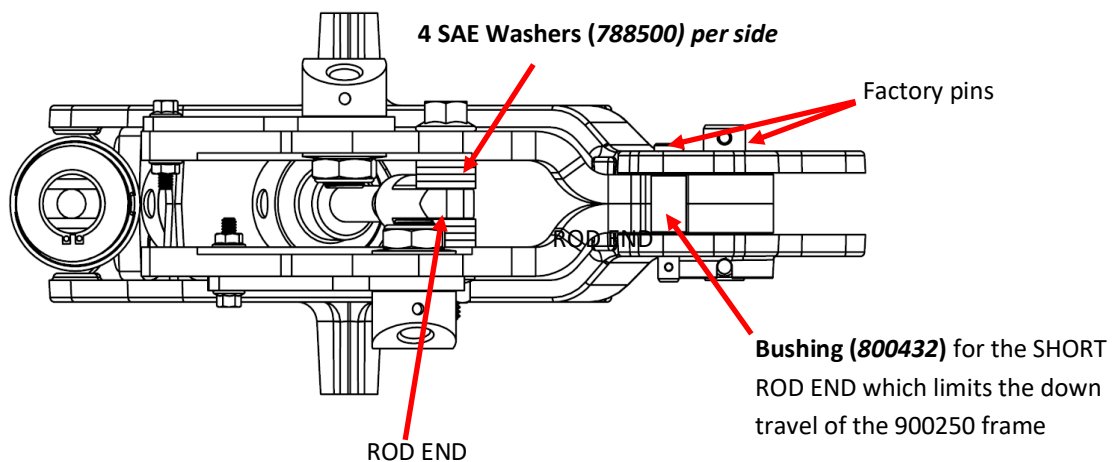

**NOTE : Bushing 800432 is an optional hardware only to be installed if you have Cylinder with short rod end.
MY18 S/N: (2140- YJS073638, 2150-12/16R FFT YJS073647) AND EARLIER WILL NEED THIS BUSHING.**

STEP 6 : INSTALL THE BSCW95ZC

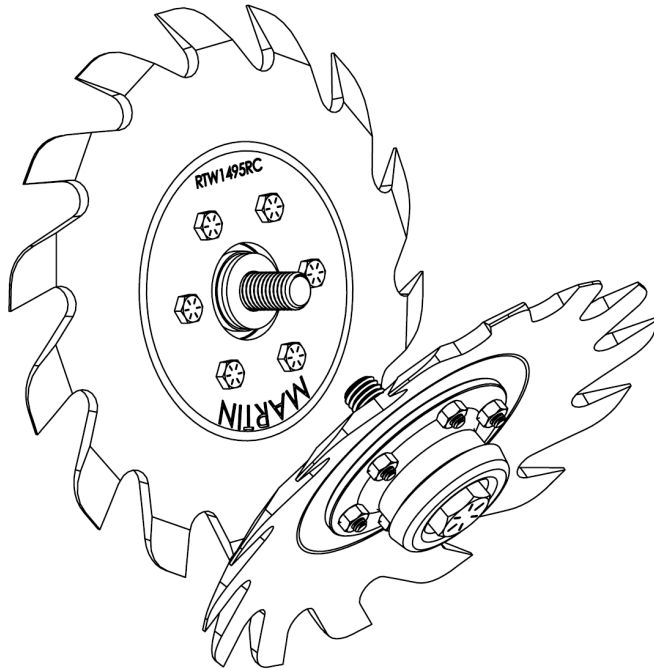

900212 (SCW-95-ZRC)

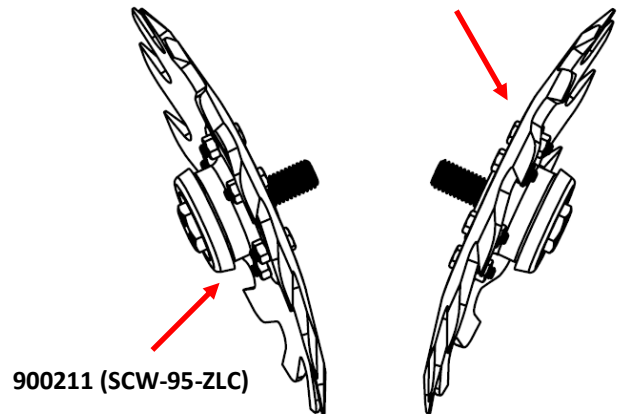

900211 (SCW-95-ZLC)

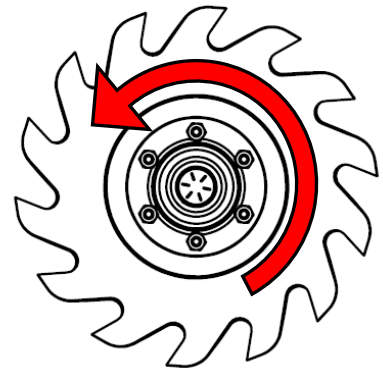

Rotation Direction

Hardware Provided

- | | |
|--------------------------------|-------|
| 1) 5/8" x 2 1/2" Bolt (784624) | Qty 2 |
| 2) 5/8" Thick Washer (788600) | Qty 4 |
| 3) 5/8" Thin Washer (788601) | Qty 4 |
| 4) Dust Cap (800274) | Qty 2 |

BSCW95ZC ASSEMBLY INSTRUCTIONS:-

- 1) Place the 800324 wheel on to the 800384 hub
- 2) Align one of the 788600 5/8" SAE thick washers on top the hub followed by a dust cap.
- 3) Insert the 5/8"-11 bolt thru 800384 hub then add the washers.

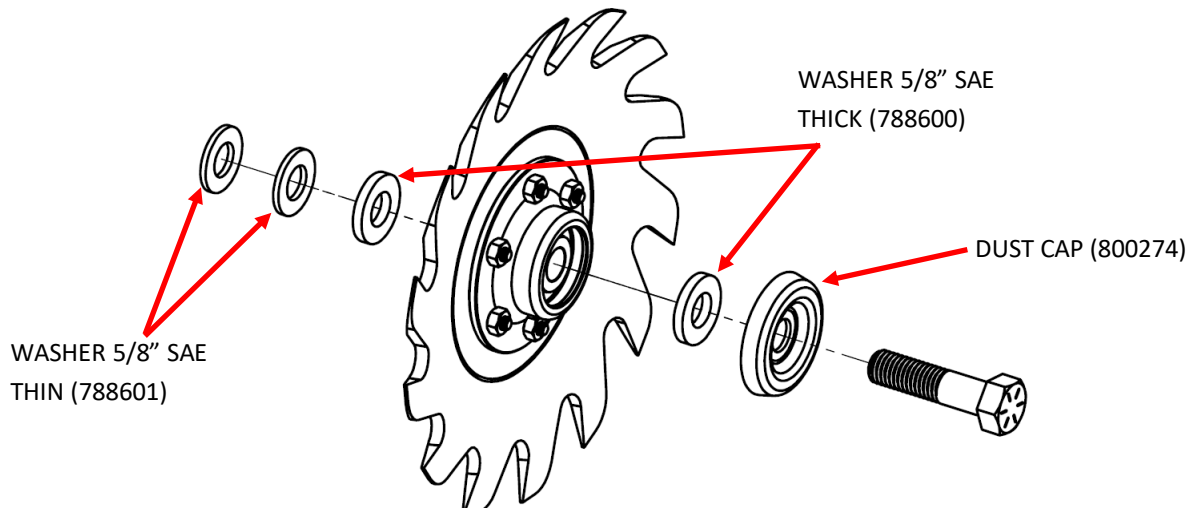

- 4) Bolt Razor wheel into 800349 stub axle through 5/8" washers (788601) and (788600)
- 5) Install 1/4" X 5/16" set screw (709032) to prevent bolt from unthreading. Primarily needed on left axle but may be used on right side if desired. **Must be loosened prior to removing Razor assembly.**

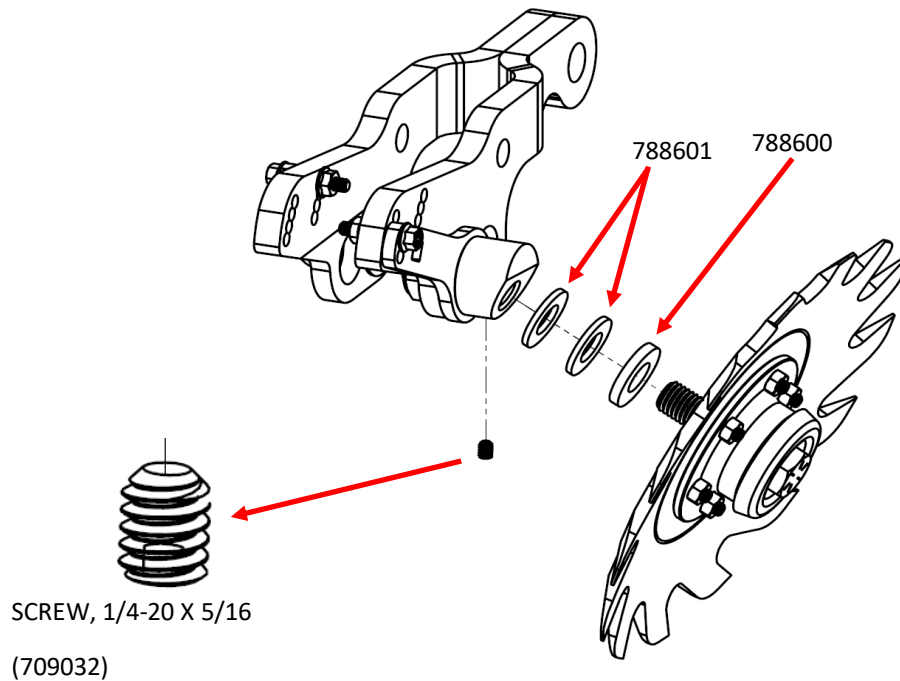

- 6) Repeat the assembly instructions for the Left hand side/opposite assembly.

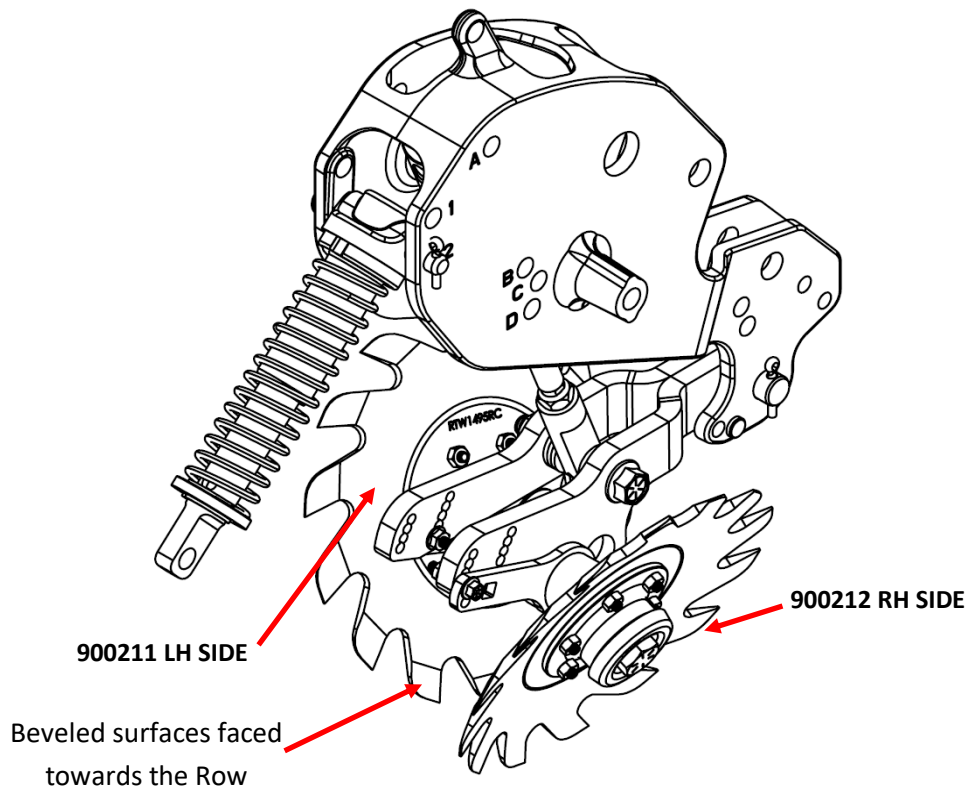

ADJUSTING WHEEL TOE-IN

Wheel Toe-in can be adjusted independently on each side providing more flexibility to adjust seed trench closure based on varying soil conditions.

To adjust, move adjusting lever (800418) up by rotating up from the neutral hole. By alternating bolt in hole 1 and hole 2 its possible to change toe in in 2 deg increments. Leaving bolt in same hole results in 4 deg increments

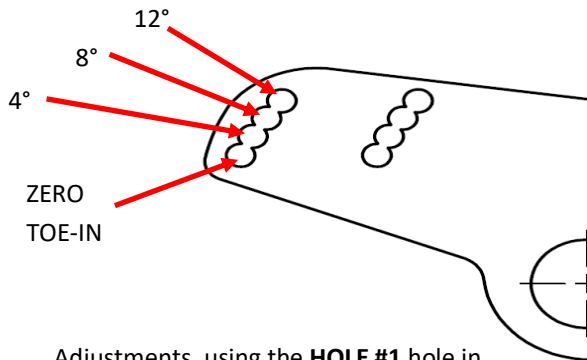

Adjustments, using the **HOLE #1** hole in the lever

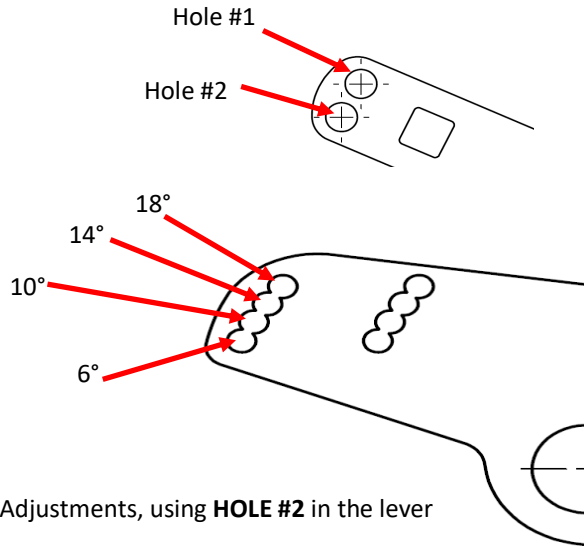

Adjustments, using **HOLE #2** in the lever

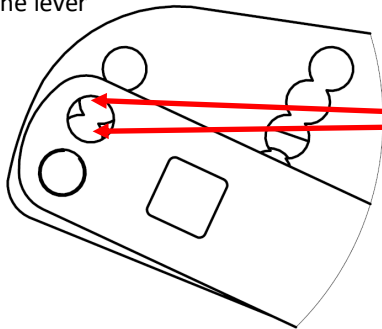

Alternating the bolt from hole #1 to Hole #2 and vice-versa will provide finer (2 degrees) of increments by rotating the adjusting lever.

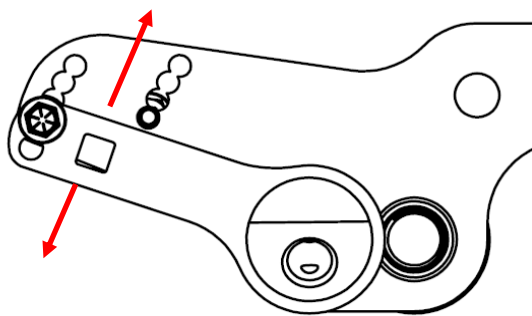

Move the adjusting lever upwards or downwards to set the desired Toe-in

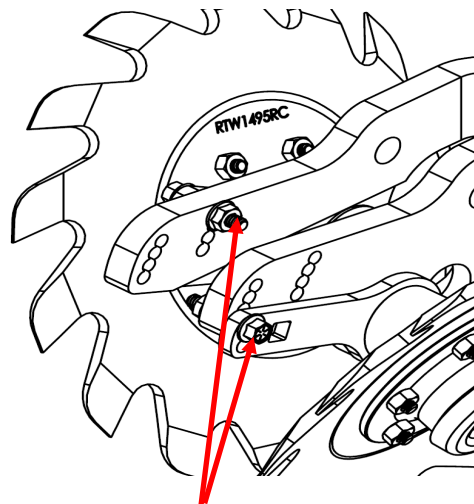

Use these 1/4" Flange bolt and nut to secure or fix the Desired Toe-in in place and tighten.

ONE WHEEL AT 8 DEGREES

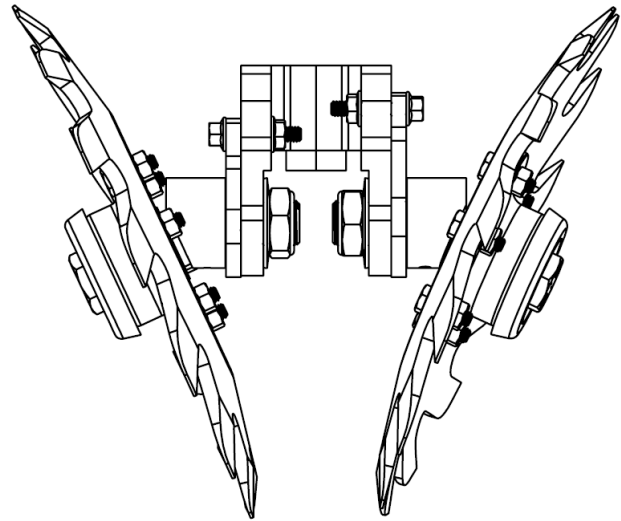
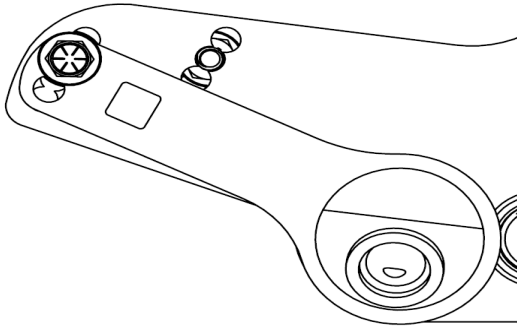

ONE WHEEL AT 10 DEGREES

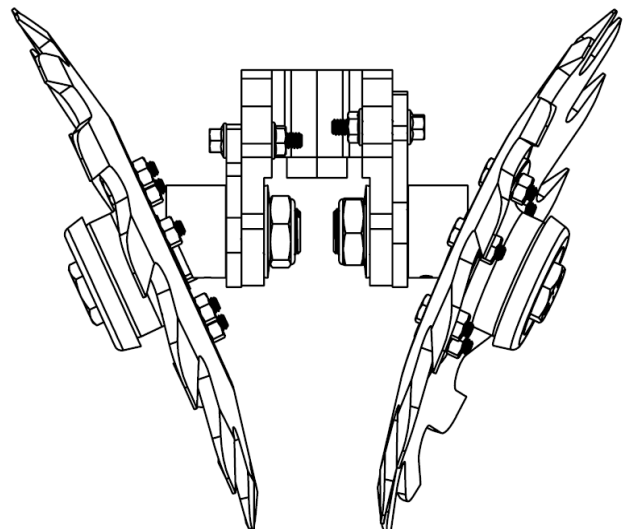
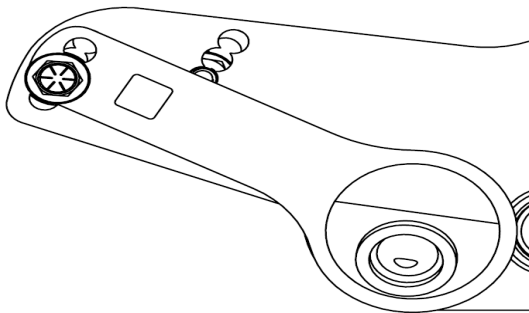

ONE WHEEL AT 12 DEGREES

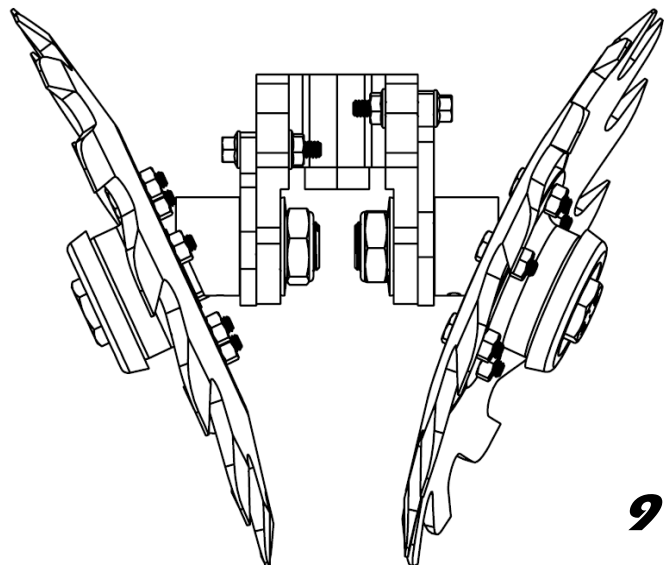
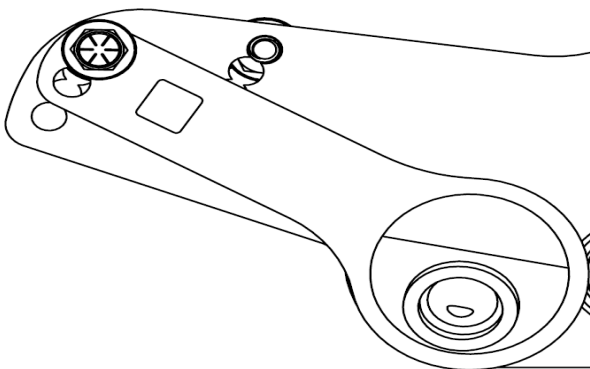

BOTH WHEELS AT 14 DEGREES

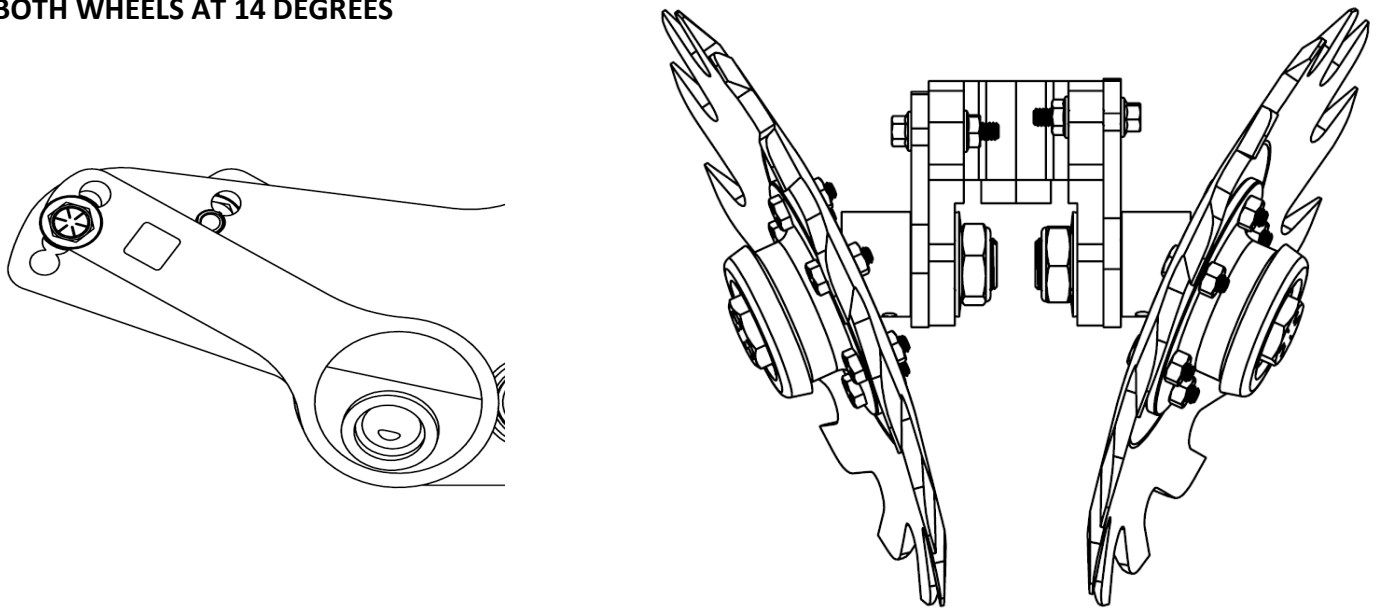

STEP 7 : INSTALL THE SWING ARM

PARTS LIST FOR 900249 Swing Arm :-

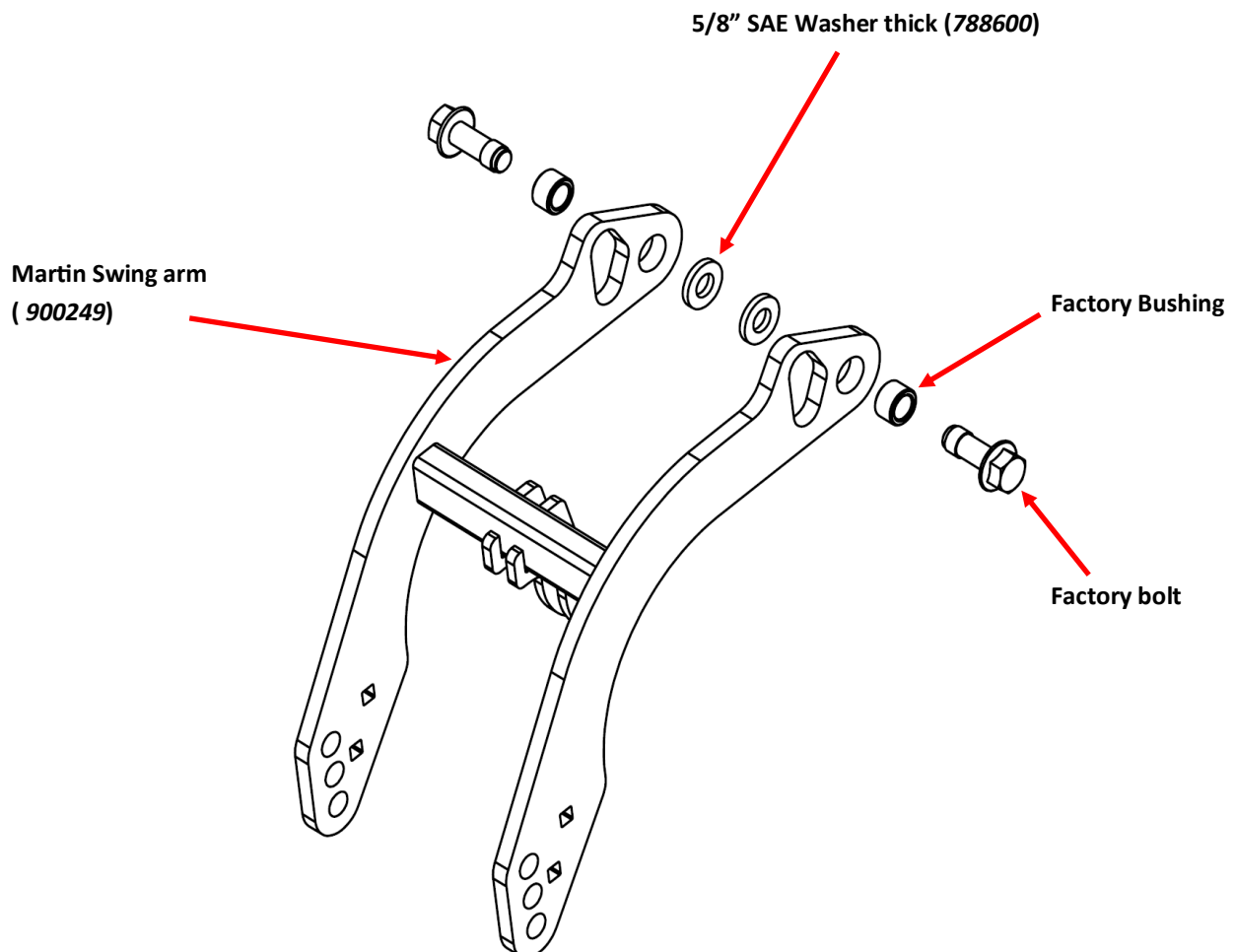

1) Once the Closing arm assembly is installed, attach the swing arm to the row unit by inserting the factory bolt through factory bushing and provided 5/8" SAE washer as shown below .

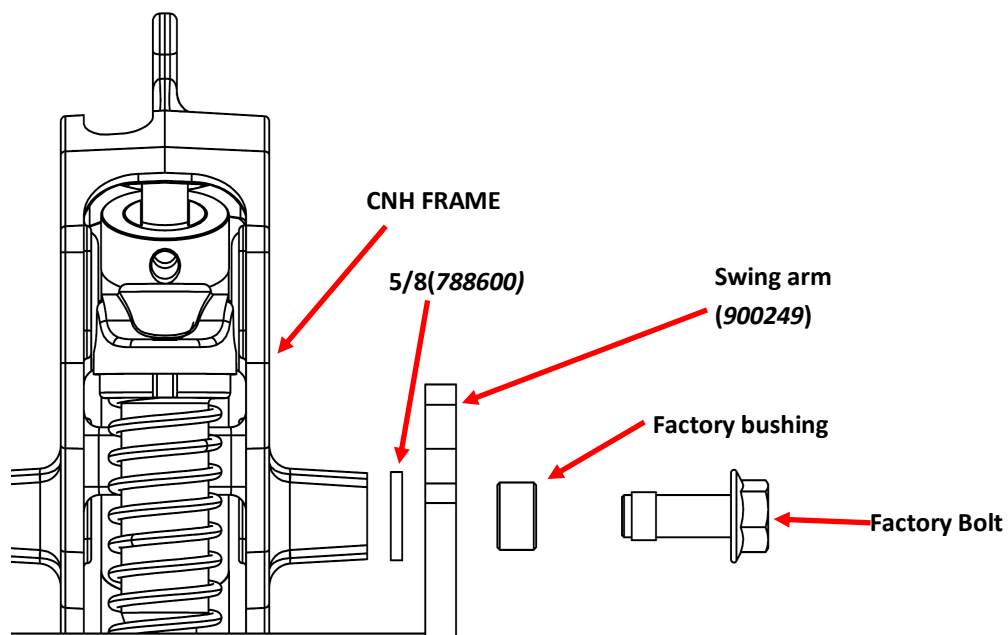

2) Reattach the factory spring assembly to the (900249) Swing arm by using existing Hardware

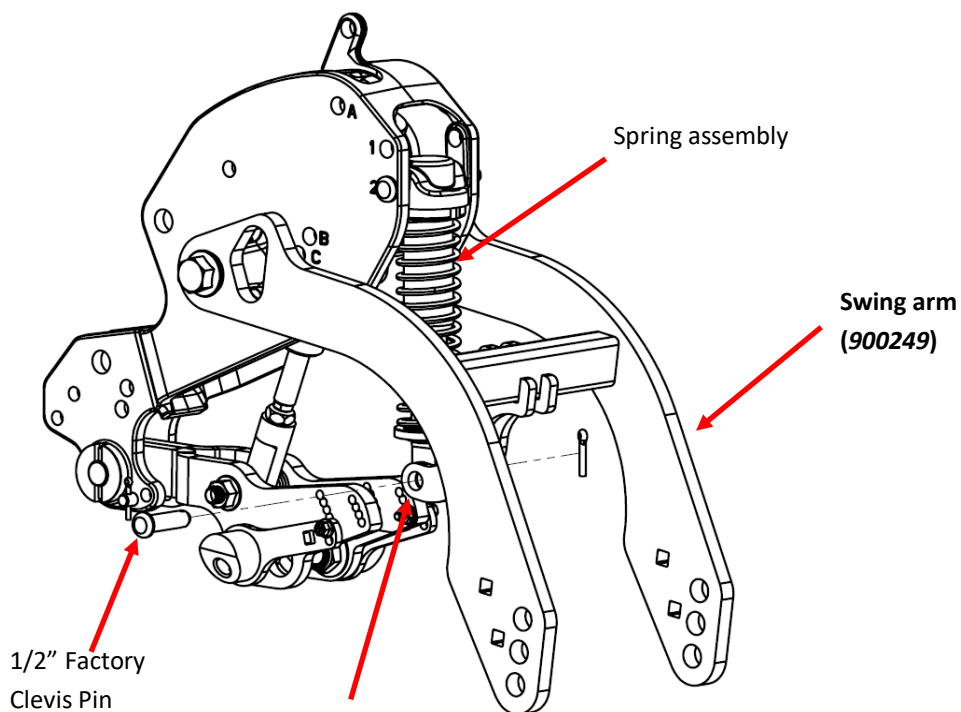

Attach the Spring assembly to the Swing Arm through these brackets

STEP 8 : INSTALL THE PRESS WHEEL

The New Martin Swing arm comes with different wheel arrangements apart from the OEM setup for the wheel

1) Choose the appropriate hole orientation.

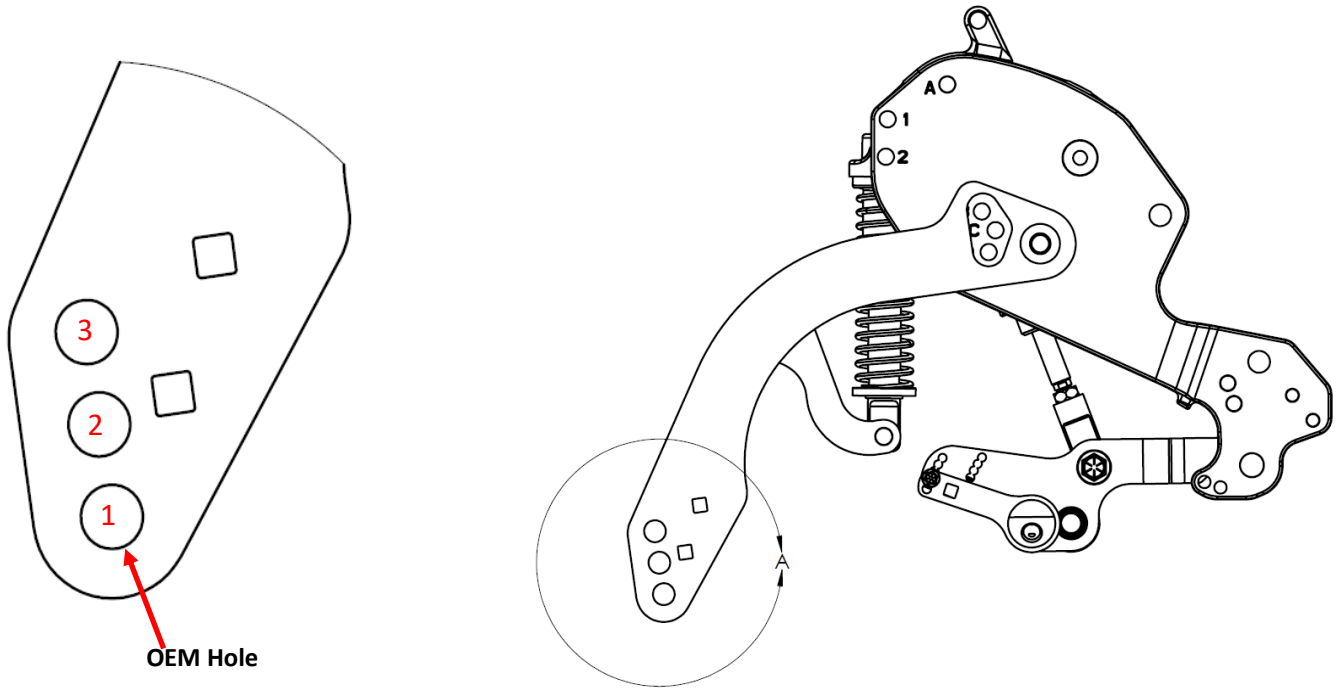

HOLE NUMBER 1 : The Hole number 1 resembles the **OEM** arrangement for the wheel

HOLE NUMBER 2 and 3 : The Hole number 2 and 3 provides us with the different loads as per the arrangement of the wheel, number 2 is less in comparison to the OEM number 1 whereas Number 3 is the least of all.

2) Once the Hole is determined, aligned the wheel to that chosen hole with the factory spacers on both sides, and the insert the long factory bolt through it and secure the other end with flange nut.

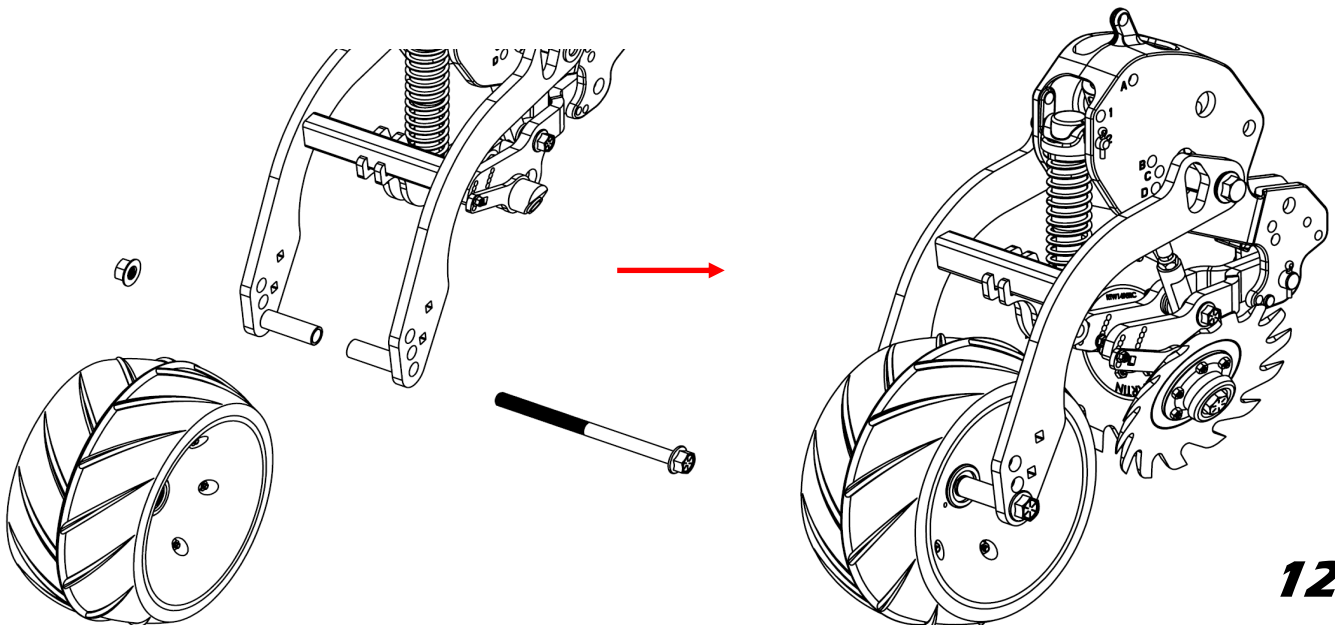

Exploded View For CNH 2000 Closing system (900252)

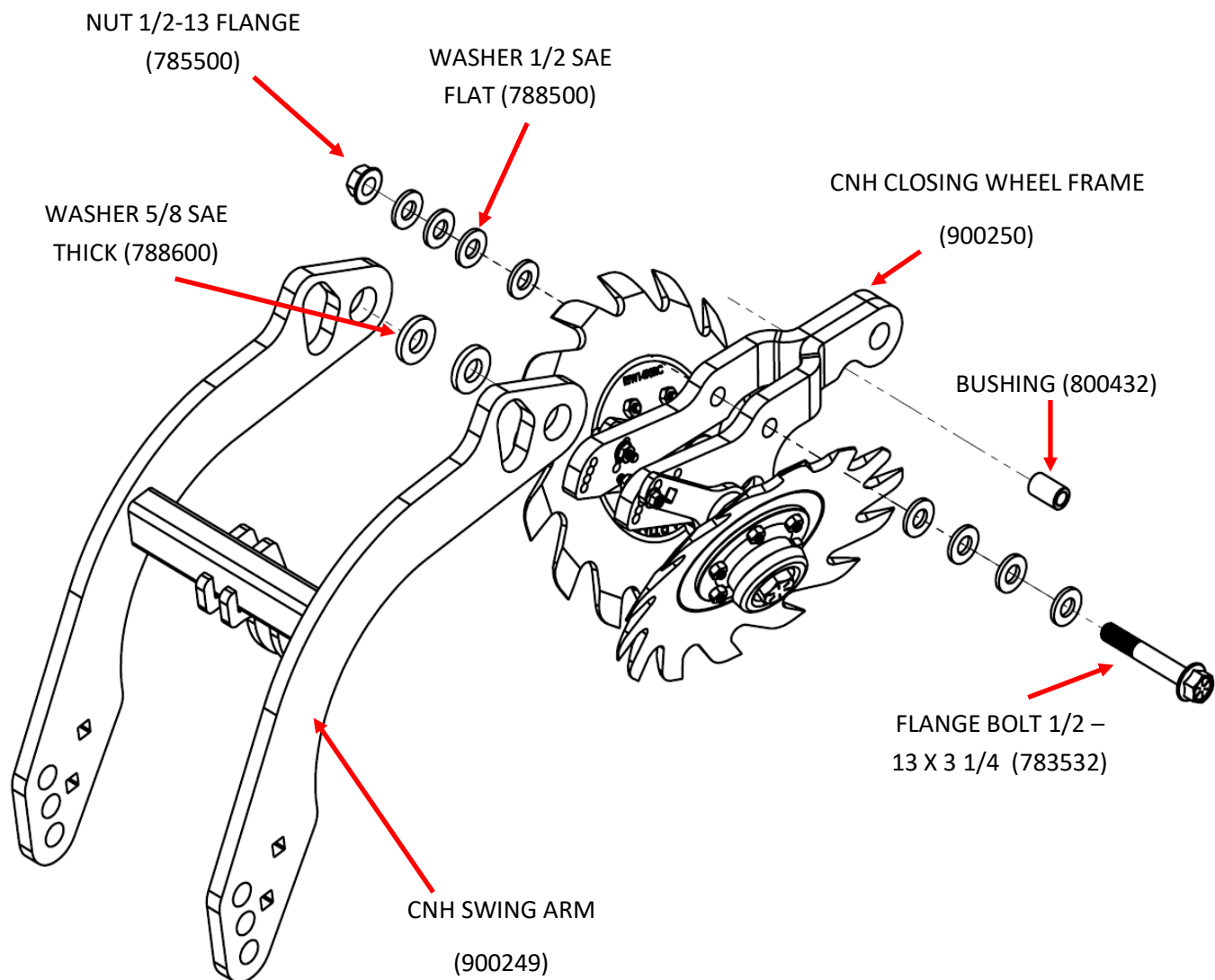

Exploded View For CNH 2000 Closer (900250)

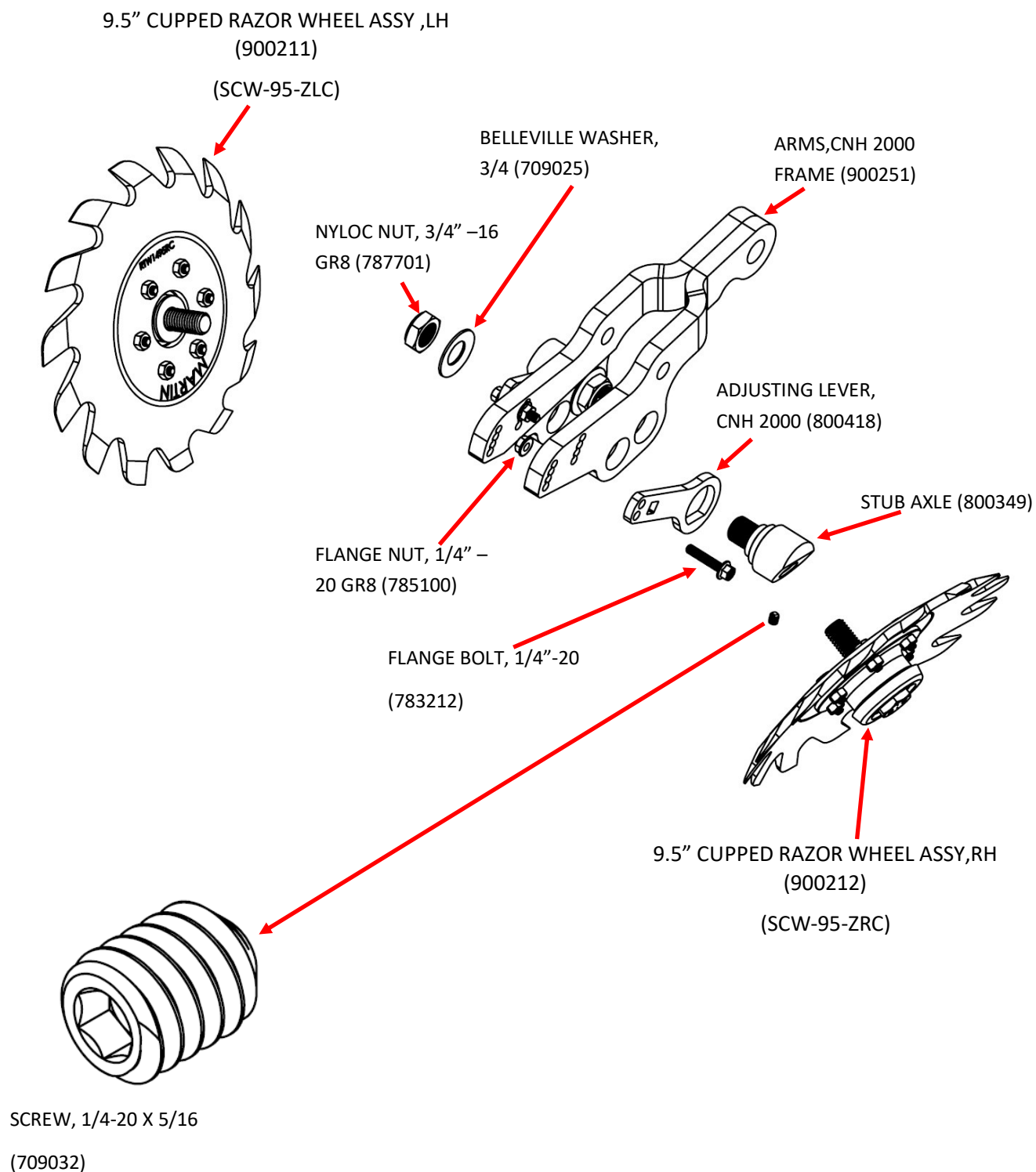

Exploded View For BSCW95ZC

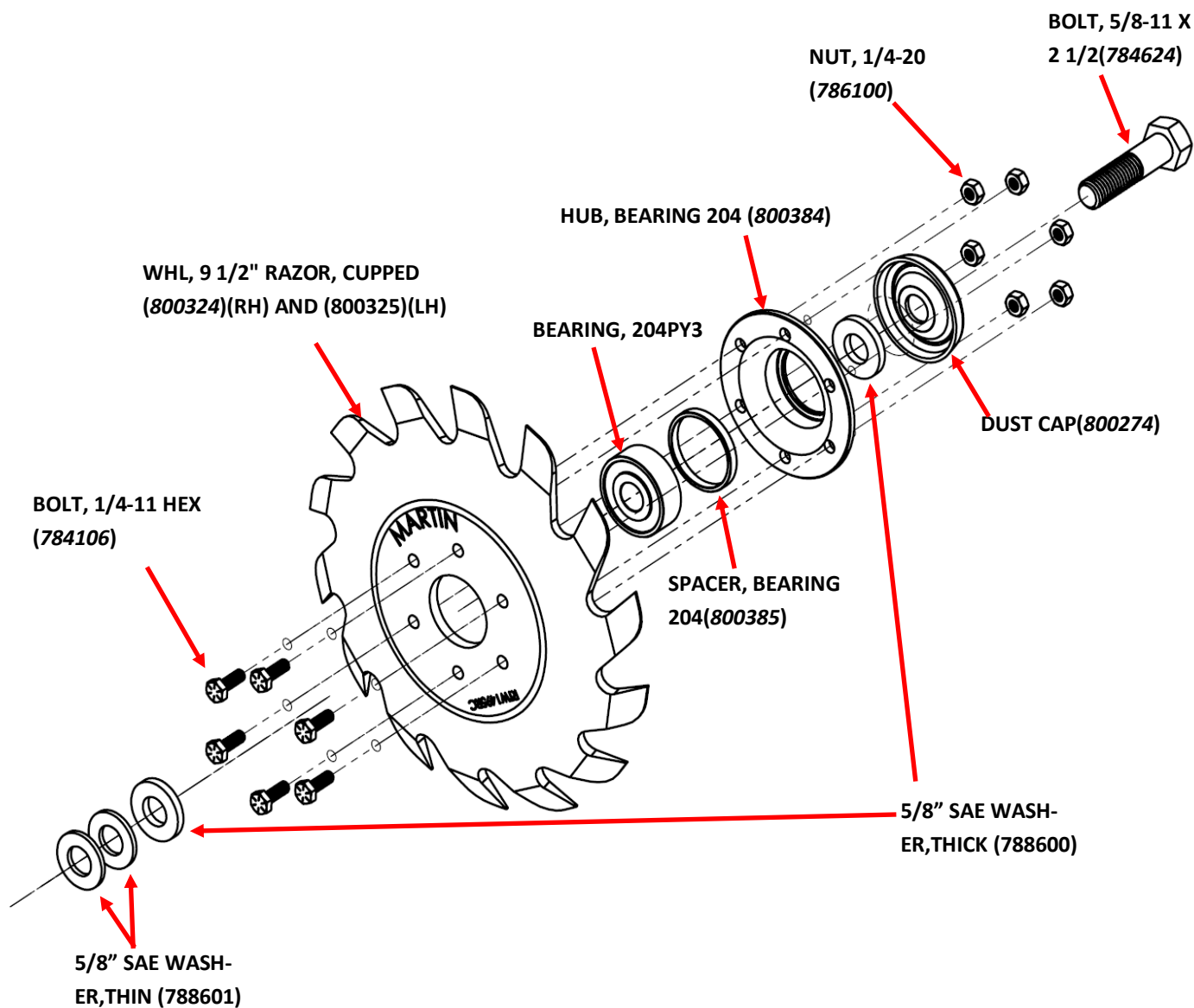

Notes

Notes

Notes



The most trusted name in no-till
Established 1991

Martin Industries LLC

206 Elk Fork Road

Elkton, KY 42220

Telephone: 270-265-5817

E-Mail: martin@martintill.com