

# SC-BKC1360 Air Cylinder Bracket Installation Instructions

## Air Cylinder Bracket Kit for Martin 1360 Row Cleaner mounted with Kinze No-Till Coulter on Kinze Planters (Series 2000 & 3000)

- Compatible with Smart Clean from Martin-Till and Clean Sweep from Precision Planting
- Packaged 4 rows per box, includes brackets and update hardware

### *Schematic of parts and locations for installation*

Om

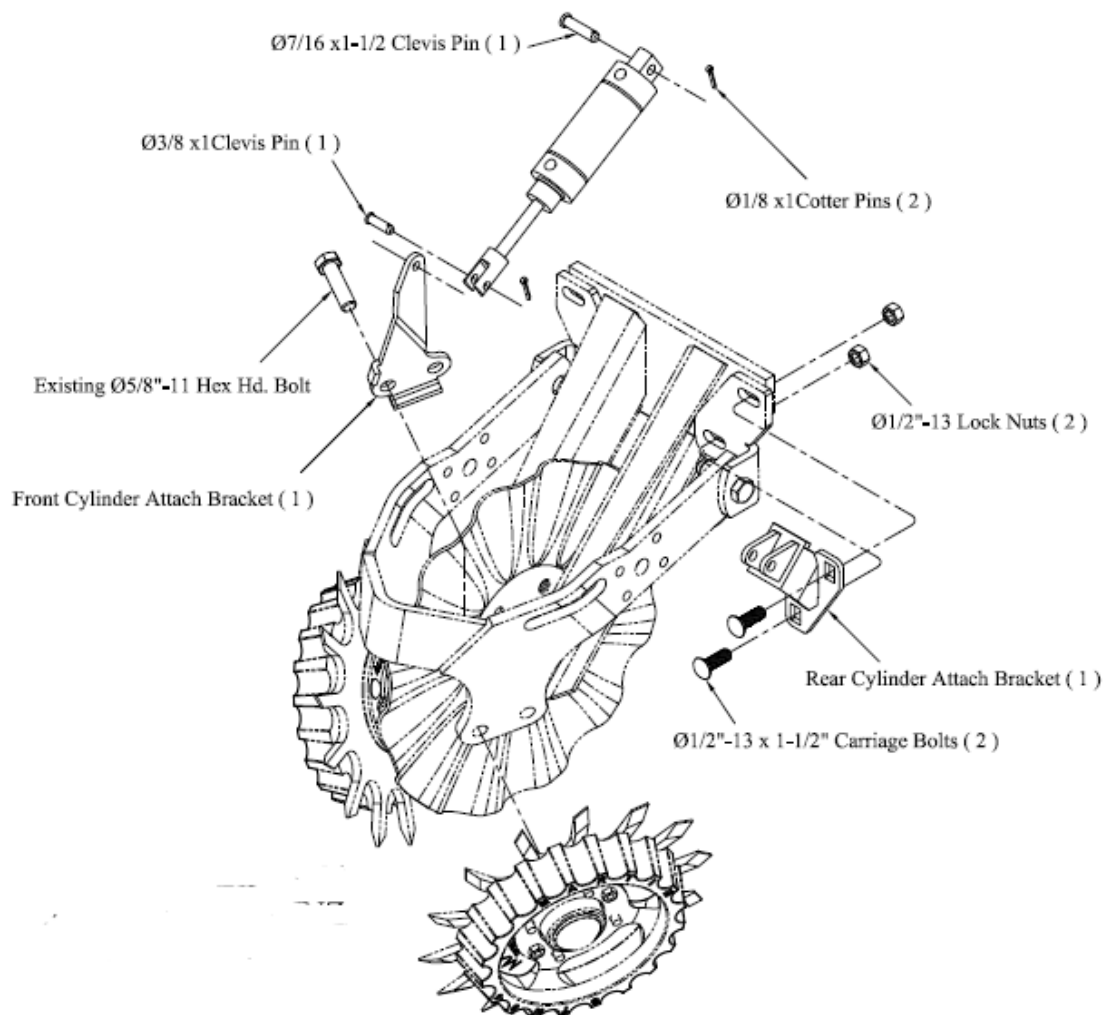

# SC-BKC1360 Air Cylinder Bracket Installation Instructions

## Instructions for updating and assembly

1. The bracket kit consists of:
  - a. 2 brackets, one that mounts to the left side of the face mount bracket in front of the coulter bracket, and one that mounts to the inside of the row cleaner frame on the left side at the bolt that holds the hub and wheel assembly to the frame.
  - b. Hardware to attach the brackets and the cylinder

## Process for Assembly

1. Remove the 2 bolts from the left side face-mount, please hold the provided rear bracket to the face-mount and use new hardware to hold bracket. Bracket will set on the coulter arm frame. Tighten bolts and nuts.
2. Remove the single bolt that holds the left wheel assembly to the row cleaner frame. Use the new provided hardware to replace current bolt. Take longer lower air cylinder bracket provided and mount on the inside of the frame with the hardware provided by using the bolt to rebolt the wheel on the row cleaner while at the same time holding the bracket in place. Retighten to manufacturers specs.
3. Install air cylinder into brackets with provided hardware. Install Clevis pins and cotter pins.
4. Make sure the air lines are properly installed to protect them. Adjust as needed and secure with zip ties if needed.